

# DIAGRAM OF LICENSED PREMISES

STATE OF CALIFORNIA  
DEPARTMENT OF ALCOHOLIC BEVERAGE CONTROL

1. FULL NAME (Last, First, Middle) <b>TRAN DUNG QUOC</b>	3. TYPE OF LICENSE <b>Type 21 off-sale</b>
2. PREMISES ADDRESS (Number & Street, City, Zip) <b>74 Pier Ave Hermosa Bch Ca 90254</b>	4. Nearest Cross Street <b>Hermosa Ave.</b>

The diagram below is a true and correct description of the entrances, exits, interior walls and exterior boundaries of the premises to be licensed, including dimensions.

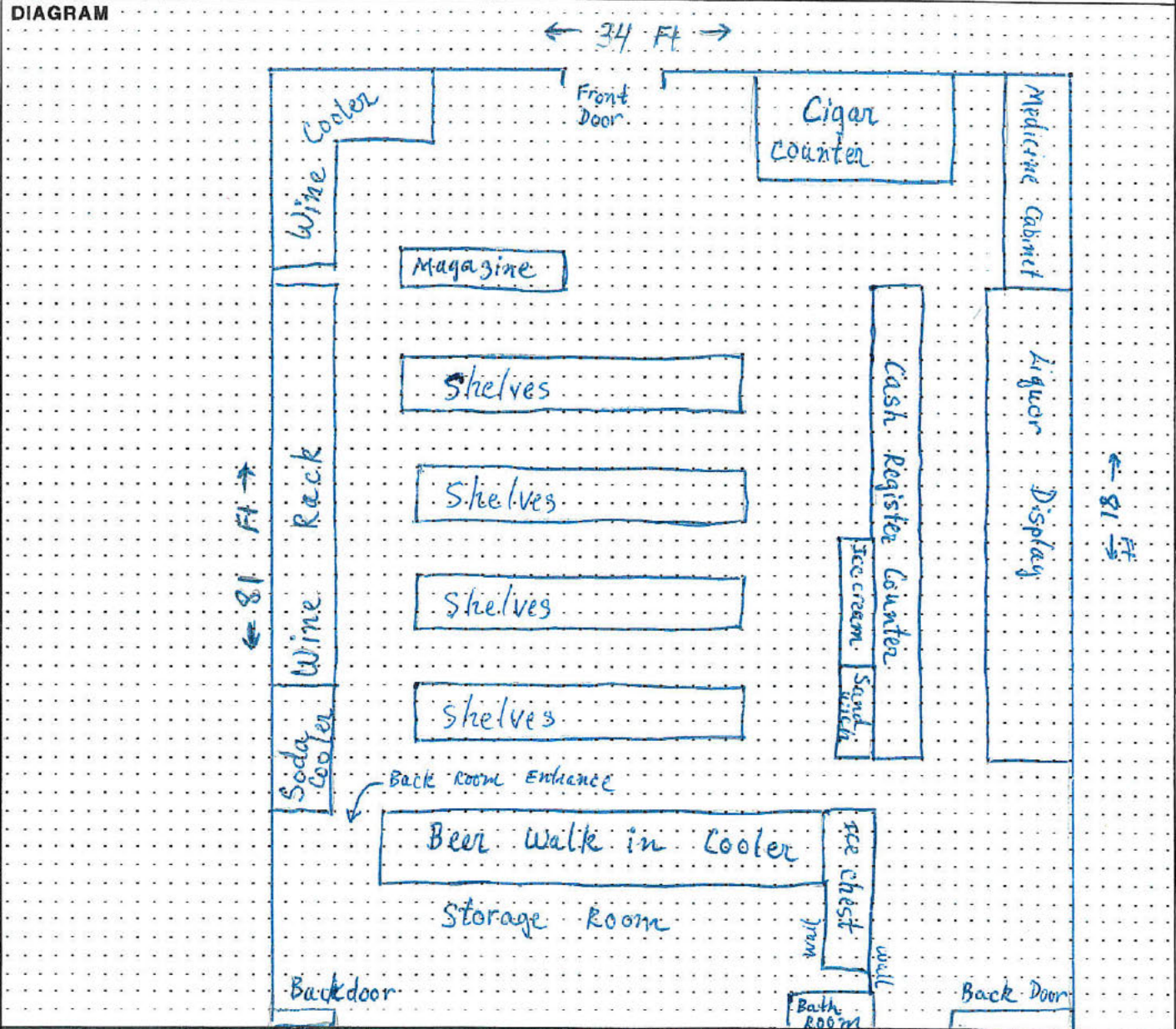

Please read carefully and sign below.

It is hereby declared that the above-described boundaries, entrances and planned operation as indicated on the reverse side, will not be changed without first notifying and securing prior written approval of the Department of Alcoholic Beverage Control. I declare under penalty of perjury that the foregoing is true and correct.

Signature of Licensee	6. DATE <b>03, 22, 96</b>
-----------------------	------------------------------

**FOR DEPARTMENT USE ONLY**

INSPECTION DATE <b>3/27/96</b>	CERTIFIED COPY
-----------------------------------	----------------